

Cabinet U-Handles

Stainless Steel

SPECIFICATION

Types

- Type **A**: Mounting from the back (threaded blind bore)
- Type **B**: Mounting from the operator's side

Handle

- Stainless steel AISI 304
- $d_1 = 20$: Solid material
 - $d_1 = 28$: Tube $\varnothing 28 \times 2$
 - Matte shot-blasted

Threaded bushing for $d_1 = 28$

Stainless steel AISI 303

Mounting stud for type B

Stainless steel AISI 303

Grub screw for type B

- Stainless steel
- $d_1 = 20$: DIN 914-M5-6-NI



INFORMATION

Cabinet U-handles GN 426.6 can be mounted from the back (type A) as well as from the operator's side (type B).

In this case the stud is first screwed in from the machine side and then the handle is pushed on and secured with the grub screw.

Both mounting methods allow the mounting of a pair of handles in opposite position. This method could be used e.g. on doors (double handle). In general, a mounting stud with special length l_2 might be required.

TECHNICAL INFORMATION

- Load Rating Information (see page A35)
- Stainless Steel Characteristics (see page A26)

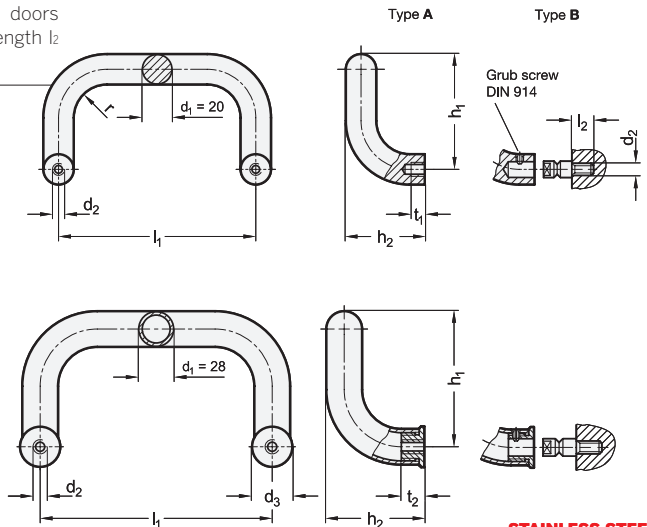

GN 426.6-A

STAINLESS STEEL

Description	d_1	$l_1 \pm 0.5$	d_2	d_3	h_1	h_2	l_2	$r \approx$	t_1	t_2	Δ
GN 426.6-20-200-A	20	200	M 8	-	105	68	20	22	15	-	1094
GN 426.6-20-300-A	20	300	M 8	-	105	68	20	22	15	-	1357
GN 426.6-28-250-A	28	250	M 10	32	128	90	20	32	-	17	820
GN 426.6-28-350-A	28	350	M 10	32	128	90	20	32	-	17	950
GN 426.6-28-500-A	28	500	M 10	32	128	90	20	32	-	17	1200

GN 426.6-B

STAINLESS STEEL

Description	d_1	$l_1 \pm 0.3$ Threaded bore for mounting stud	d_2	d_3	h_1	h_2	l_2	$r \approx$	t_1	t_2	Δ
GN 426.6-20-200-B	20	200	M 8	-	105	68	20	22	15	-	1112
GN 426.6-20-300-B	20	300	M 8	-	105	68	20	22	15	-	1360
GN 426.6-28-250-B	28	250	M 10	32	128	90	20	32	-	17	870
GN 426.6-28-350-B	28	350	M 10	32	128	90	20	32	-	17	1020
GN 426.6-28-500-B	28	500	M 10	32	128	90	20	32	-	17	1205